



ART-21200 SERIES DOODLEBUG GAS ELECTRIC RAIL CAR

EXPLODED PARTS DIAGRAM

#1 Gauge 1:29 SCALE

+

+

+

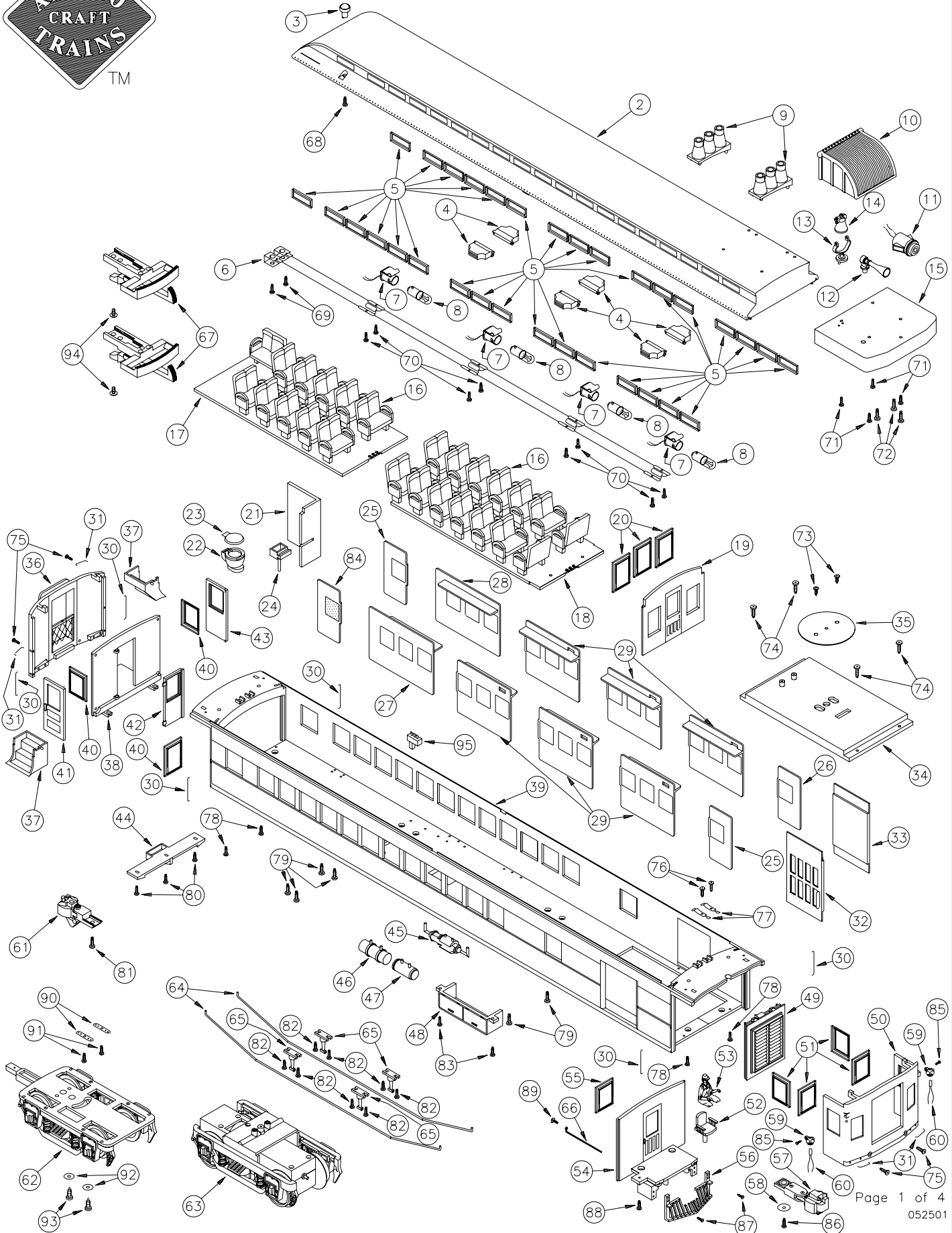

ART-21200 SERIES DOODLEBUG GAS ELECTRIC RAIL CAR

PARTS LIST-ORDER FORM



SPECIFY ROADNAME/ART#: _____ Insert Quantity

Part #	Description *	Price	Quantity Ordered
1 21200-01	Instruction Manual		
2 212XX-02	Roof		
3 212XX-03	Toilet Vent		
4 21200-04	Car Vent		
5 21200-05	Skylight Window		
6 21200-06	Car Interior Light Bus		
7 21200-07	Interior Light Socket		
8 21200-08	Interior Light Bulb		
9 212XX-09	Exhaust Stack		
10 212XX-10	Radiator		
11 212XX-11	Headlight		
12 212XX-12	Horn		
13 212XX-13	Bell Harp		
14 212XX-14	Bell		
15 212XX-15	Cab Roof		
16 21200-16	Seats		
17 21200-17	Module 1		
18 21200-18	Module 2		
19 212XX-19	Compartment Wall		
20 21200-20	Compartment Wall Window		
21 212XX-21	Lavatory Wall and Door		
22 21200-22	Commode		
23 21200-23	Commode Lid		
24 21200-24	Lavatory Sink		
25 21200-25	R.H. Single Pane Window		
26 21200-26	L.H. Single Pane Window		
27 21200-27	R.H. 3 Pane Window		
28 21200-28	L.H. 3 Pane Window		
29 21200-29	Center 3 Pane Window		
30 21200-30	Vertical Grabiron		
31 21200-31	Horizontal Grabiron		
32 212XX-32	Baggage Door Right		
33 212XX-33	Baggage Door Left		
34 21200-34	Power Truck Mounting Box		
35 21200-35	A Frame Retainer Plate		
36 212XX-36	Car End		
37 21200-37	Steps		
38 212XX-38	Vestibule Wall		
39 212XX-39	Car Body		
40 21200-40	Entrance Door Window		
41 212XX-41	R.H. Car Entrance Door		
42 212XX-42	Interior Entrance Door		
43 212XX-43	L.H. Entrance Door		
44 21200-44	Moveable Bolster		
45 21200-45	Brake Cylinder		
46 21200-46	Long Air Tank		
47 21200-47	Short Air Tank		
48 21200-48	Battery Box		
49 21200-49	Moveable Louver		
50 212XX-50	Body Front		
51 21200-51	Body Front Window		
52 21200-52	Chair		
53 21200-53	Engineer		
54 212XX-54	Front Vestibule		
55 21200-55	Front Vestibule Window		
56 21200-56	Pilot		
57 21200-57	Knuckle Coupler Front		
58 21200-58	Knuckle Coupler Front Washer		
59 21200-59	Marker Light		
60 21200-60	Marker Light Bulb		
61 21200-61	Knuckle Coupler Rear		
29109	2 Axle Heavyweight Truck		
29351	2 Axle Power Truck		
21200-64	Truss Rod		
21200-65	Truss Rod Stanchion		
21200-66	Coupler Spring		
21200-67	Plastic Loop/Hook Coupler (2 pcs.)		

SPECIFY ROADNAME/ART#: _____ Insert Quantity

Part #	Description *	Price	Quantity Ordered
68 21200-68	Toilet Vent Screw		
69 21200-69	Interior Light Bus Tab Screw		
70 21200-70	Interior Light Bus Retainer Screw		
71 21200-71	Radiator Screw		
72 21200-72	Cab Roof Screw		
73 21200-73	A Frame Retainer Plate Screw		
74 21200-74	Power Truck Mounting Box Screw		
75 21200-75	Car End Mounting Screw		
76 21200-76	Roof Light Tab Screw		
77 21200-77	Roof Light Tab		
78 21200-78	Car End Screw		
79 21200-79	Module Screw		
80 21200-80	Bolster Mounting Screw		
81 21200-81	Rear Coupler Screw		
82 21200-82	Stanchion Screw		
83 21200-83	Battery Box Screw		
84 21200-84	Frosted Glass Window		
85 21200-85	Marker Light Mounting Screw		
86 21200-86	Front Coupler Screw		
87 21200-87	Pilot Mounting Screw		
88 21200-88	Chair Mounting Screw		
89 21200-89	Coupler Spring Screw		
90 21200-90	Wire Tab		
91 21200-91	Wire Tab Screw		
92 21200-92	Heavyweight Truck Washer		
93 21200-93	Bolster Screw		
94 21200-94	Plastic Loop/Hook Coupler Screw		
95 21200-95	On / Off Switch		

* one piece unless otherwise noted

ART-21200 SERIES DOODLEBUG GAS ELECTRIC RAIL CAR

PARTS LIST-ORDER FORM



SPECIFY ROADNAME/ART#: _____ Insert Quantity Ordered

Part #	Description *	Price	Quantity Ordered
Ⓐ 29111B	Black Metal Wheel		
Ⓑ 29110-11	2 Axle Bolster		
Ⓒ 29110-12	2 Axle Sideframe		
Ⓓ 29110-13	Sideframe Lower Spring Support		
Ⓔ 29110-06	Spring		
Ⓕ 29110-02	Sideframe Bushing		
Ⓖ 29110-08	Wire Eye Tab		
Ⓗ 29110-10	Sideframe Mounting Screw		
Ⓘ 29351-01	"A" Frame		
Ⓝ 22500-87	Power Truck Sideframe		
Ⓧ 22500-83	Power Truck Sideframe Mounting Screw		
Ⓛ 29351-02	"A" Frame Mounting Screw		
Ⓜ 29351-13	Motor Block Upper Case		
Ⓝ 29351-14	Motor Block Lower Case		
Ⓞ 29351-15	Motor Block Retaining Screw		
Ⓟ 29351-16	Motor with Worm		
Ⓠ 29351-17	Bushing for Worm Shaft		
Ⓡ 29351-18	Gear Case - Rear Half		
Ⓢ 29351-19	Gear Case - Front Half		
Ⓣ 29351-20	Gear Case - Retaining Screws		
Ⓤ 29351-21	Gear Case Retaining Nuts		
Ⓡ 29351-22	Universal		
Ⓜ 29128	Thrust Ball Bearings, Worm Shaft (2 pcs.)		
Ⓧ 29351-13	Power Pick Up - Front Right		
Ⓜ 29351-14	Power Pick Up - Front Left		
Ⓡ 29351-15	Power Pick Up - Rear Right		
Ⓢ 29351-16	Power Pick Up - Rear Left		
Ⓣ 29351-17	Worm and Shaft, for Gear Case		
Ⓤ 29351-18	Gear Axle		
Ⓡ 29351-19	Washer for Axle		
Ⓢ 29127	Ball Bearing for Axle (4 pcs.)		
Ⓣ 29351-20	Wheel		
Ⓤ 29351-21	Star Washer		
Ⓡ 29351-22	Screw for Power Pick Ups		
Ⓢ 29351-23	Wheel Retaining Screw		
Ⓣ 29351-24	Allen Screw for Universal		
Ⓤ 29351-25	Modular Plug and Leads for Motor		
Ⓡ 29351-26	Modular Plug and Leads for Power Pick Ups		
Ⓢ 21200-99	Parts List - Order Form		

*one piece unless otherwise noted

RETURN THIS FORM WITH YOUR ORDER
A REPLACEMENT FORM WILL BE SENT WITH YOUR ORDER

NOTE: When ordering replacement parts or repair request, please refer to proper 5 or 7 digit number listed. XX refers to last two digits of roadname ART DOODLEBUG number when part is painted to match, i.e. ART-21202 B & O. 31702-39 would then refer to CAR BODY for B & O DOODLEBUG RAIL CAR ART-21202. If part is same FOR ALL DOODLEBUG RAIL CARS, 2102-plus 2 digit number would be used to denote specific part, i.e. 21200-22 Commode used on ALL DOODLEBUG RAIL CARS regardless of railroad name. When part is same FOR ALL DOODLEBUG RAIL CARS AND OTHER LOCOMOTIVES, 29200 (or other #-plus 2 digit number) would be used to denote specific part regardless of roadname/car type. Please specify roadname/ART# on line above part# list and always when ordering parts by phone/fax/letter.

Unpainted/painted part(s) will be substituted if the painted to match part(s) ordered are not available.
In addition to Price Each shown please enclose...
\$5.00 shipping/handling if part order is less than \$10.00 or \$10.00 shipping/handling if part order is \$10.00 or more.

This is for part order only. Not WARRANTY order.

Include proper payment for parts plus shipping/handling with your (USA Bank Account Only) check/money order payable in US Dollars (\$) to: Polk's Hobbies. Please DO NOT SEND CASH. Sorry no C.O.D.'s for parts.

New Jersey residents add 6% NJ State Sales Tax.

Be Sure to include your name, street address (no Post Office Box please), city, state (or province), country (if outside USA), and postal zip code, along with daytime phone number including Area Code, so that you may be contacted if necessary.

Mail order form and payment to:

ARISTO-CRAFT TRAINS/Polk's Modelcraft Hobbies, Inc.
698 South 21st Street
Irvington, NJ 07111-4109 USA

Allow 4-6 weeks for processing and delivery.

PLEASE PRINT CLEARLY

NAME: _____

ADDRESS _____

CITY: _____ STATE: _____ ZIP _____

PHONE:(_____) - _____ - _____