

ART-22700 SERIES EGGLINER LOCOMOTIVE

EXPLODED PARTS DIAGRAM

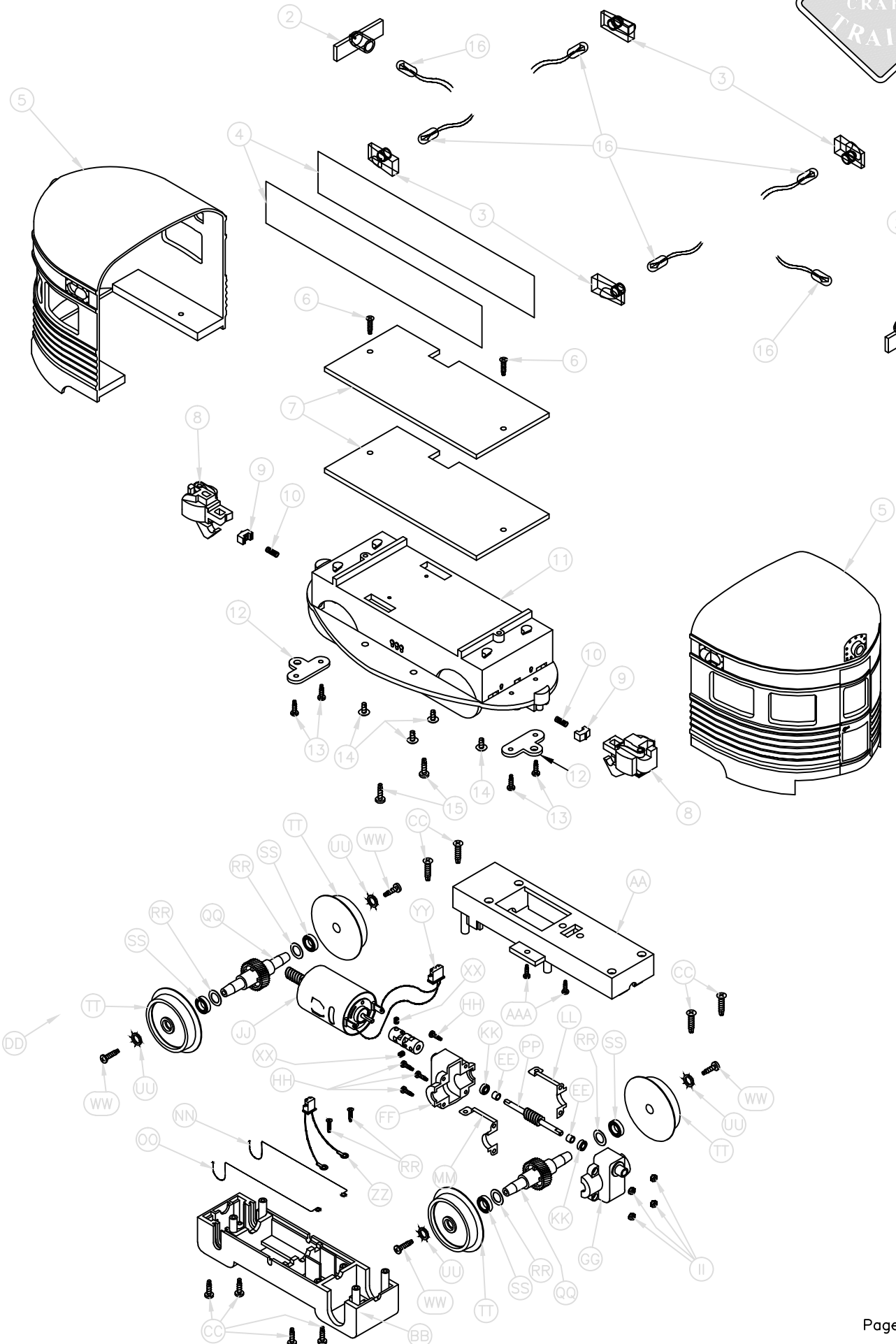

ART-22700 SERIES EGGLINER LOCOMOTIVE

PARTS LIST-ORDER FORM



SPECIFY ROADNAME/ART#: _____ Insert Quantity

Part #	Description *	Price	Quantity Ordered
① 22700-01	Instruction Manual		
② 22700-02	Car End Center Lights		
③ 22700-03	Car End Side Lights		
④ 22700-04	Window Glass		
⑤ 22700-05	Car End Eggliner		
⑥ 22700-06	Weight Retaining Screw		
⑦ 22700-07	Weight (each)		
⑧ 22700-08	Knuckle Coupler (each)		
⑨ 22700-09	Shank Pivot		
⑩ 22700-10	Centering Spring		
⑪ 22700-11	Eggliner Frame		
⑫ 22700-12	Coupler Cover		
⑬ 22700-13	Coupler Cover Screw		
⑭ 22700-14	Body Mounting Screw		
⑮ 22700-15	Power Truck Mounting Screw		
⑯ 22700-16	Bulb		
Ⓐ 29351-02	Mounting Screws		
Ⓑ 29351-03	Motor Block Upper Case		
Ⓒ 29351-04	Motor Block Lower Case		
Ⓓ 29351-05	Motor Block Retaining Screws		
Ⓔ ART-29408	Motor with Worm		
Ⓕ 29351-07	Bushing for Worm Shaft		
Ⓖ 29351-08	Gear Case - Rear Half		
Ⓗ 29351-09	Gear Case - Front Half		
Ⓘ 29351-10	Gear Case Retaining Screws		
Ⓚ 29351-11	Gear Case Retaining Nuts		
Ⓛ ART-29353	Universal		
Ⓜ ART-29469	Thrust Ball Bearings for Worm Shaft (2 pcs)		
Ⓝ 29351-13	Power Pick Up - Front Right		
Ⓟ 29351-14	Power Pick Up - Front Left		
Ⓠ 29351-15	Power Pick Up - Rear Right		
Ⓡ 29351-16	Power Pick Up - Rear Left		
Ⓢ 29351-17	Worm and Shaft for Gear Case		
Ⓣ 29351-18	Geared Axle		
Ⓤ 29351-19	Washer for Axle		
Ⓡ ART-29410	Ball Bearing for Axle (4 pcs)		
Ⓡ 29351-20	Wheel		
Ⓡ 29351-21	Star Washer		
Ⓡ 29351-22	Screws for Power Pick Ups		
Ⓡ 29351-23	Wheel Retaining Screw		
Ⓡ 29351-24	Allen Screws for Universal		
Ⓡ 29351-25	Modular Plug and Leads for Motor		
Ⓡ 29351-26	Modular Plug and Leads for Power Pick Ups		
Ⓡ 29101-99	Plastic Loop/Hook Couplers (2 pcs.)		
Ⓡ 31000-99	Parts List-Order Form		

*one piece unless otherwise noted

RETURN THIS FORM WITH YOUR ORDER
A REPLACEMENT FORM WILL BE SENT WITH YOUR ORDER

NOTE: When ordering replacement parts or repair request, please refer to proper 5 or 7 digit number listed.

XX refers to last two digits of roadname ART freight car number when part is painted to match, i.e. ART-22701 SANTE FE (SILVER). 22701-03 would then refer to BODY SHELL for SANTE FE (SILVER) EGGLINER LOCOMOTIVE ART-22701. If part is same FOR ALL EGGLINER LOCOMOTIVES, 22700-plus 2 digit number would be used to denote specific part, i.e. 22700-04 WINDOW GLASS. When part is same FOR ALL EGGLINER LOCOMOTIVES and OTHER FREIGHT CARS, 29200 (or other #-plus 2 digit number) would be used to denote specific part regardless of roadname/car type. Please specify roadname/ART# on line above part# list.

Unpainted/painted part(s) will be substituted if the painted to match part(s) ordered are not available.

In addition to Price Each shown please enclose...
\$5.00 shipping/handling if part order is less than \$10.00 or
\$10.00 shipping/handling if part order is \$10.00 or more.
This is for part order only. Not WARRANTY order.

Include proper payment for parts plus shipping/handling with your (USA Bank Account Only) check/money order payable in US Dollars (\$) to: Polk's Hobbies. Please DO NOT SEND CASH. Sorry no C.O.D.'s for parts.

New Jersey residents add 6% NJ State Sales Tax.

Be Sure to include your name, street address (no Post Office Box please), city, state (or province), country (if outside USA), and postal zip code, along with daytime phone number including Area Code, so that you may be contacted if necessary.

Mail order form and payment to:

ARISTO-CRAFT TRAINS/Polk's Modelcraft Hobbies, Inc.
698 South 21st Street
Irvington, NJ 07111-4109 USA

Allow 4-6 weeks for processing and delivery.

PLEASE PRINT CLEARLY

NAME: _____

ADDRESS _____

CITY: _____ STATE: _____ ZIP _____

PHONE: (_____) - _____ - _____