



ART-42200 SERIES BOBBER CABOOSE

EXPLODED PARTS DIAGRAM

#1 1:29
Gauge SCALE

+

+

+

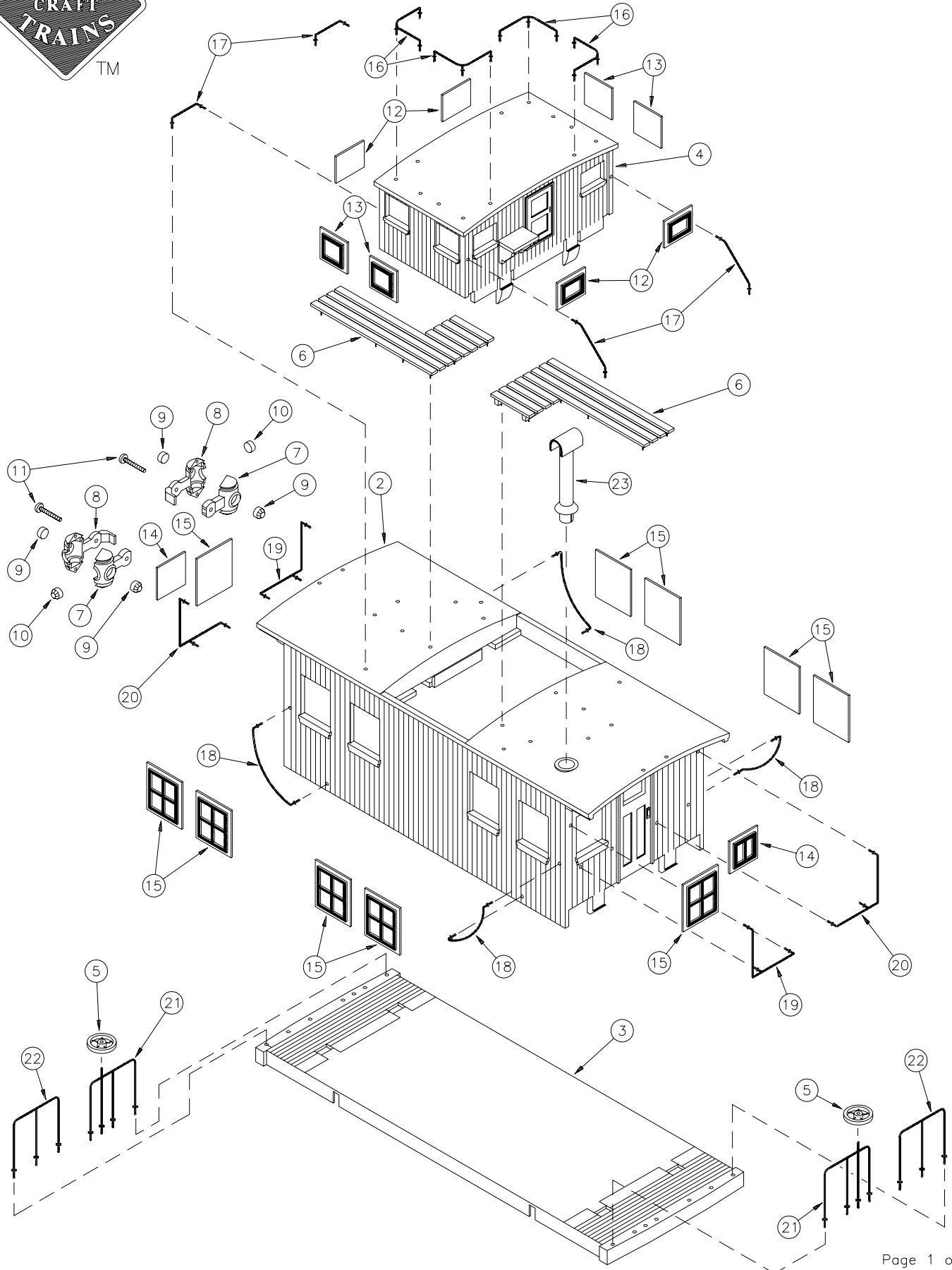

ART-42200 SERIES BOBBER CABOOSE

PARTS LIST-ORDER FORM



SPECIFY ROADNAME/ART#: _____ Insert Quantity Ordered

Part #	Description *	Price	Quantity Ordered
①	42200-01 Instruction Manual		
②	422XX-02 Bobber Caboose Body (Except LTD./Special edition)		
③	42200-03 Underframe		
④	422XX-05 Bobber Caboose Cupola (Except LTD./Special Edition)		
⑤	42200-11 Brakewheel		
⑥	42200-16 Long Roofwalk		
⑦	42200-40 Marker Light-Black Plastic-Front w/o Lens		
⑧	42200-41 Marker Light-Black Plastic-Rear w/o Lens		
⑨	42200-50 Marker Light Lens-Red		
⑩	42200-51 Marker Light Lens-Green		
⑪	42200-88 Marker Light Mounting Screw (pair)		
⑫	42200-60 Clear Plastic Window w/Trim-Cupola End		
⑬	42200-61 Clear Plastic Window w/Trim-Cupola Side		
⑭	42200-62 Clear Plastic Window w/Trim-Door		
⑮	42200-63 Clear Plastic Window w/Trim-Body Side/End		
⑯	42200-70 Cupola Plastic Grabrailing-Corner		
⑰	42200-71 Cupola Plastic Grabrailing-Support		
⑱	42200-72 Plastic Grabrailing-Body Side		
⑲	42200-73 Plastic Grabrailing-Body End Left		
⑳	42200-74 Plastic Grabrailing-Body End Right		
㉑	42200-75 Plastic Grabrailing-Platform Left w/o Brakewheel		
㉒	42200-76 Plastic Grabrailing-Platform Right		
㉓	42200-90 Smokestack Black Plastic (non-operating)		
Ⓐ	29104 Plastic Wheel Set (2 axles w/ 4 wheels)		
Ⓑ	42200-02 Sideframe w/o Springs-Axle Journal Box		
Ⓒ	42200-03 Axle Journal Box		
Ⓓ	29101-99 Freight Truck Spring (2 pcs.)		
Ⓔ	29200-02 Coupler Drawhead Shank		
Ⓕ	29200-03 Shank Pivot		
Ⓖ	29200-04 Centering Spring		
Ⓗ	29200-85 Centering Screw		
Ⓖ	29200-06 Coupler Mounting Bracket		
Ⓜ	29200-87 Mounting Screw		
Ⓝ	29200-08 Centering Shaft		
Ⓞ	29200-09 Drawhead Spring		
Ⓟ	29200-10 Knuckle Tab		
Ⓠ	29200-11 Knuckle Spring		
Ⓡ	29200-12 Knuckle Head		
Ⓢ	29200-13 Drawhead Bottom Plate		
Ⓣ	29200-84 Plate Mounting Screw (2 pcs.)		
Ⓤ	42200-82 Underframe Screw (2 pcs.)		
Ⓧ	29200 Coupler-Knuckle (2 pcs.)		
Ⓩ	29101-69 Plastic Loop/Hook Couplers (2 pcs.)		
⑳	42200-99 Parts List-Order Form		

*one piece unless otherwise noted

RETURN THIS FORM WITH YOUR ORDER
A REPLACEMENT FORM WILL BE SENT WITH YOUR ORDER

NOTE: When ordering replacement parts or repair request, please refer to proper 5 or 7 digit number listed.

XX refers to last two digits of roadname ART freight car number when part is painted to match, i.e. ART-42207 JERSEY CENTRAL. 42207-02 would then refer to Body for JERSEY CENTRAL BOBBER CABOOSE ART-42207. If part is same FOR ALL BOBBER CABOOSES, 42200-plus 2 digit number would be used to denote specific part, i.e. 42200-03 Underframe. When part is same FOR ALL BOBBER CABOOSES AND OTHER FREIGHT CARS, 29200 (or other) -plus 2 digit number would be used to denote specific part regardless of roadname/car type.

Please specify roadname/ART# on line above part# list.
Unpainted/painted part(s) will be substituted if the painted to match part(s) ordered are not available.

In addition to Price shown please enclose...
\$5.00 shipping/handling if part order is less than \$10.00 or \$10.00 shipping/handling if part order is \$10.00 or more.
This is for part order only. Not WARRANTY order.

Include proper payment for parts plus shipping/handling with your (USA Bank Account Only) check/money order payable in US Dollars (\$) to: Polk's Hobbies. Please DO NOT SEND CASH. Sorry no C.O.D.'s for parts.

New Jersey residents add 6% NJ State Sales Tax.

Be Sure to include your name, street address (no Post Office Box please), city, state (or province), country (if outside USA), and postal zip code, along with daytime phone number including Area Code, so that you may be contacted if necessary.

Mail order form and payment to:

ARISTO-CRAFT TRAINS/Polk's Modelcraft Hobbies, Inc.
698 South 21st Street
Irvington, NJ 07111-4109 USA

Allow 4-6 weeks for processing and delivery.
PLEASE PRINT CLEARLY

NAME: _____
ADDRESS _____
CITY: _____ STATE: _____ ZIP _____
PHONE: (____) - ____ - _____

